

W:\Projects\Redwood County Highway Department\40738\2023-11916\CADD\Civil\CDR-2023-11916-TRAFFIC-CONTROL.dwg Plotted by Jeff Chnr 5/29/2025 2:02:48 PM

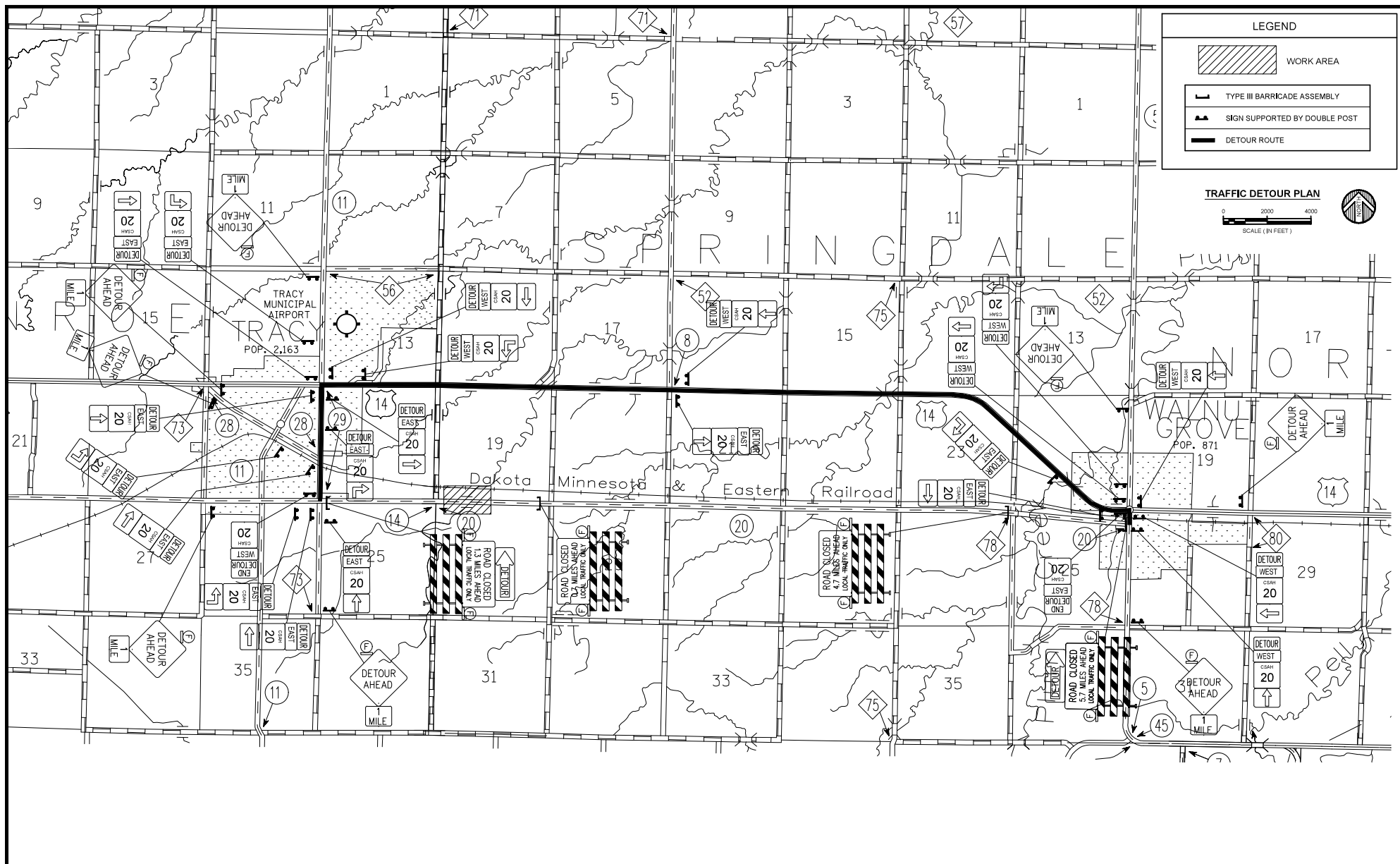

		I HEREBY CERTIFY THAT THIS PLAN WAS PREPARED BY ME OR UNDER MY DIRECT SUPERVISION AND THAT I AM A DULY LICENSED PROFESSIONAL ENGINEER UNDER THE LAWS OF THE STATE OF MINNESOTA.		CERTIFIED BY: LICENSED PROFESSIONAL ENGINEER NAME: ANDREW J. MUER	05/30/2025 DATE LIC. NO. 59945		TRAFFIC DETOUR PLAN S.P. NO. 064-620-011	DES. BY: A.J.M. DR. BY: J.J.E. CHK. BY: A.J.M. CHK. BY: P.J.S.	JOB NUMBER: 2023-11916	BRIDGE NO. 1195 OLD	
REV. NO.	DATE	REVISION DESCRIPTION	BY	© 2025 WIDSETH SMITH HOLDING & ASSOCIATES, INC.							