

PROJECT LOCATION

— SAP 064-611-013
 On CSAH 11 between 305th St. and
 Minnesota River
 Replace Br. 64501
 Construct Br. 64609

W:\Projects\Redwood County Highway Department-40738\2023-11569\CADD\Civil\APPROACHES\C-TC-2023-11569-TRAFFIC.dwg Plotted by: Jeff Chilar 3/25/2026 1:30:30 PM

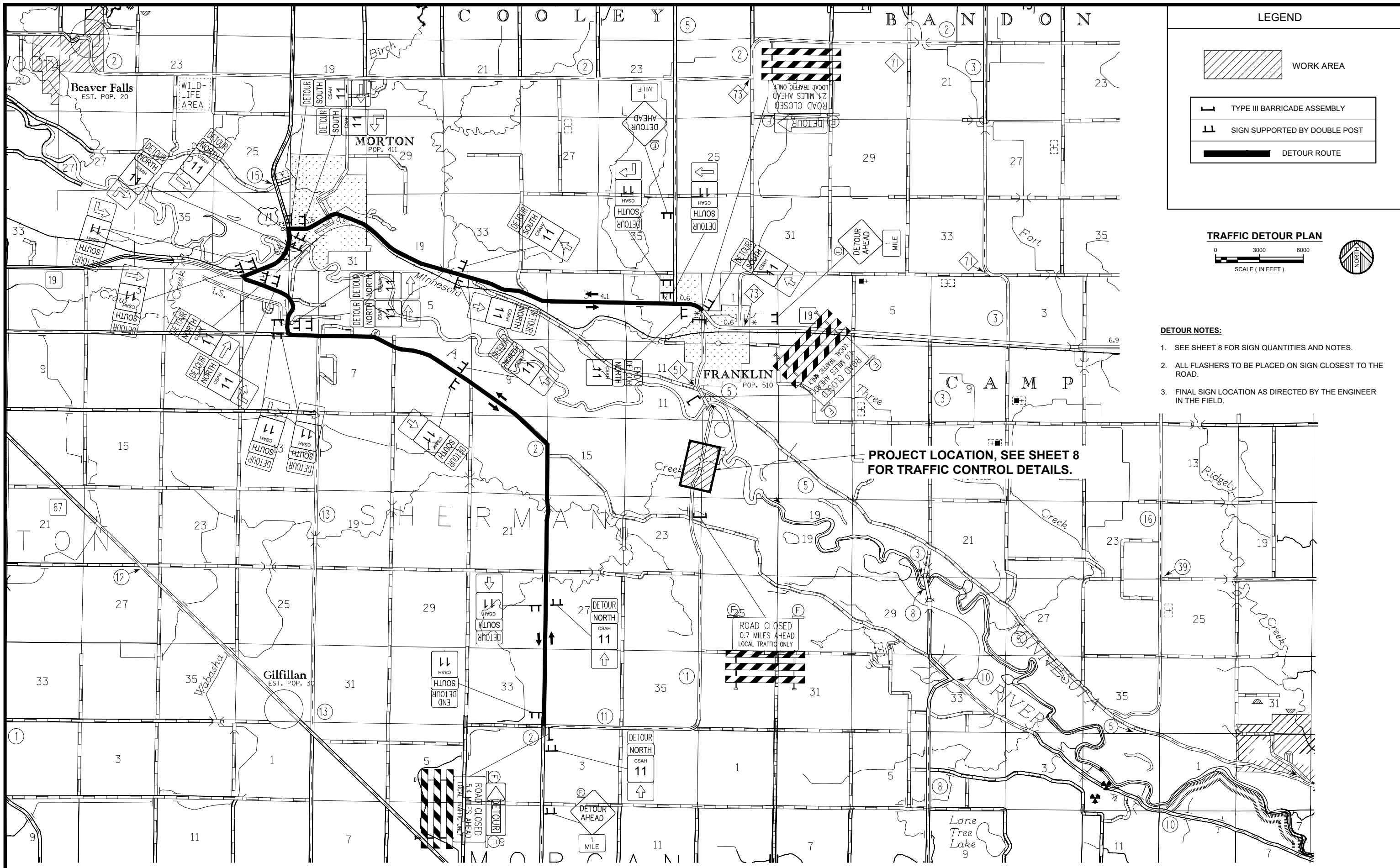

LEGEND

- WORK AREA
- TYPE III BARRICADE ASSEMBLY
- SIGN SUPPORTED BY DOUBLE POST
- DETOUR ROUTE

TRAFFIC DETOUR PLAN

0 3000 6000
SCALE (IN FEET)

- DETOUR NOTES:**
- SEE SHEET 8 FOR SIGN QUANTITIES AND NOTES.
 - ALL FLASHERS TO BE PLACED ON SIGN CLOSEST TO THE ROAD.
 - FINAL SIGN LOCATION AS DIRECTED BY THE ENGINEER IN THE FIELD.

PROJECT LOCATION, SEE SHEET 8 FOR TRAFFIC CONTROL DETAILS.

REV. NO.	DATE	REVISION DESCRIPTION	BY

I HEREBY CERTIFY THAT THIS PLAN WAS PREPARED BY ME OR UNDER MY DIRECT SUPERVISION AND THAT I AM A DULY LICENSED PROFESSIONAL ENGINEER UNDER THE LAWS OF THE STATE OF MINNESOTA

CERTIFIED BY:
 LICENSED PROFESSIONAL ENGINEER
 NAME: ANDREW J. MUER
 DATE: 03/26/2026
 LIC. NO. 59945

WIDSETH
 ARCHITECTS • ENGINEERS • SCIENTISTS • SURVEYORS

TRAFFIC DETOUR PLAN
 SAP NO. 064-611-013

DES. BY: A.J.M. DR. BY: G.A.M.
 CHK. BY: A.J.M. CHK. BY: N.G.K.
 JOB NUMBER: 2023-11589
SHEET NO. 7 OF 21 SHEETS

BRIDGE NO. 64609